

LEGEND- AREA/PART UNDER PROPOSED REVISION IS SHOWN THIS- [Purple Box]

DR: [Signature] DATE: 10/05/2019

APPROVED BY: [Signatures]

(RAJAN KUMAR SHARMA) JP (H/O)

(VIKAS) ATP (H/O)

(GANGA) DTP (H/O)

(RISHI SHARMA) STP (H/O)

(AMIT KUMAR) DTP (H/O)

(AMIT KUMAR) DTP (H/O)

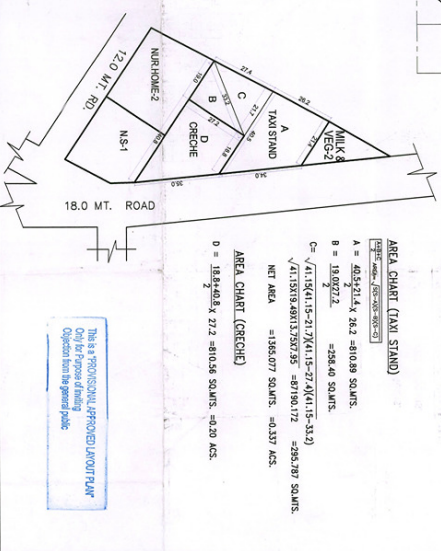

**AREA CHART (TAXI STAND)**

A =  $42.5514 \times 4.2 = 180.89$  SQ.MTS.

B =  $18.0 \times 7.2 = 130.72$  SQ.MTS.

C =  $47.156115 \times 21.714115 = 1024.15$  SQ.MTS.

NET AREA =  $1385.077$  SQ.MTS.  $\approx 317$  ACRES.

**AREA CHART (CRECHE)**

D =  $18.0 \times 8.8 \times 7.2 = 116.64$  SQ.MTS.  $\approx 26$  ACRES.

This is a PROVISIONAL APPROVED LAYOUT PLAN. Only for reference of making application to the planning office.

REV. LAYOUT PLAN	NO.	DATE	BY	FOR
1	1	10/05/2019	[Signature]	PROVISIONAL APPROVED LAYOUT PLAN

REQUIREMENT	PROVIDED	REMARKS
NURSERY SCHOOL	3	3
PRIMARY SCHOOL	2	2
RELIGIOUS BUILDING	1	1
DISPENSARY	1	1
COMMUNITY CENTRE	1	1
SUB. POST OFFICE	1	1
CLUB	2	2
AMC	2	2
BEAUTY PARLOUR	2	2
MULTIPURPOSE ROOM	2	2
MALL & VES.	2	2
NURSERY HOME	2	2

3. DENSITY	PROVIDED	REMARKS
1) MAN/FLOT	12/33	12/33
2) S.M.E.	2/225	2/225
TOTAL	14/148	14/148 PERSONS
	14/148	34.415 P.P.A

2. DETAIL OF PLOTS	AREA (SQ.MT.)	NO.	TOTAL AREA (SQ.MT.)
A	260,000.0	19	15,500.0
B	11,200.0	19	48,720.0
BI	15,007.2	408	2,026.0
B2	15,000.73	404,95	2,768.70
B3	4,297.2	3,003	7,910
C	12,000.0	3,000	65,500.0
CI	12,303.0	282.9	2,561
DC	12,000.0	2,400	22,000.0
E	8,000.0	179	28,800.0
F	4,002.5	500	11,200.0
TOTAL	1,123	21,739.4	67,883 ACRES

**1. DETAIL OF LAND:**

TOTAL AREA OF SCHEME (14,148+13,700) = 15,001 ACRES.

AREA UNDER UNDERTAKEN USE = 0.163 ACRES.

NET AREA = 14,838 ACRES.

AREA UNDER NURSERY HOME = 0.700 ACRES.

(2 WORKROOM SOLAR ECHO) = 0.59 ACRES.

AREA UNDER COMMERCIAL USE = 5,694 ACRES. (3.79%)

TOTAL SHADABLE AREA = 7,577 ACRES. (49.70%)

REV. LAYOUT PLAN OF RESIDENTIAL COLONY AT VILLAGE THIRI & FAZIRPUR - JHANSI, GURGAON (NABEY VITUL WORLD)

Authorised Signatory: [Signature]

Architect: Nareesh Kumar Rampal, CA/2000/2800, NABEY VITUL WORLD